

Courses up the Creek
 Beg^d at Post
 N 50 W 103
 N 70 W 14
 N 84 W 41
 N 40 W 22 to Hick^y
 180 perches.

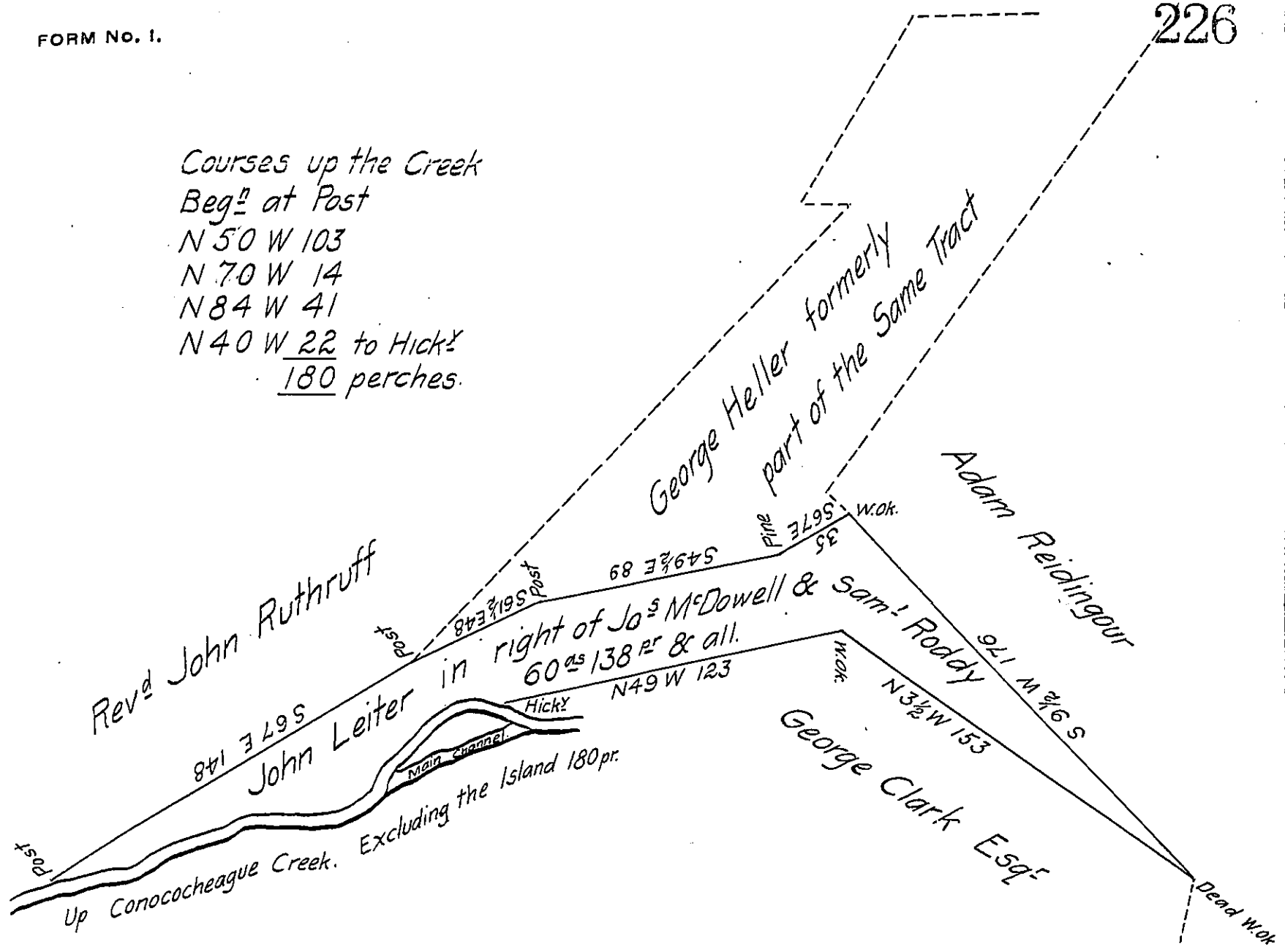

A Draught of a Tract of Land situated in Montgomery Township Franklin County Containing Sixty acres and One hundred and thirty eight perches and Allowance of Six p. Cent for Roads &c. being part of a larger tract of One hundred and thirty nine acres and one hundred and thirteen perches & Allowance &c. which was Surveyed March 28th 1782 in pursuance of ~~an Order of Survey granted to Joseph McDowell Dated Jan^y 16th 1767 No^o 2477~~ And a Warrant granted Samuel Roddy Dated December 9th 1773

Resurveyed and laid off from the other parts of the Tract for John Leiter August 29th 1810 # say 29th Dec^r 1773.
 Thomas Poe D.S.

To Andrew Porter Esq^r
 Surveyor General of Penn^a

IN TESTIMONY that the above is a copy of the original remaining on file in the Department of Internal Affairs of Pennsylvania, made conformably to an Act of Assembly approved the 16th day of February, 1833, I have hereunto set my Hand and caused the Seal of said Department to be affixed at Harrisburg, this twenty eighth day of September 1906.

George D. Brown
 Secretary of Internal Affairs.